

Stainless steel folded paper towel dispenser



≡ *Stainless steel folded paper towel dispenser*

- ≡ The folded-paper towel dispenser type E is lockable and made entirely of stainless steel.
- ≡ The level indicator on the side makes it easy to maintain. The dispenser is refilled by opening the front panel.
- ≡ The dispenser's robust design makes it suitable for universal use, e.g. in public, high-traffic or vandal prone areas.
- ≡ The folded paper towel dispenser is supplied with a wall bracket and stainless steel, wire mesh waste-paper basket.
- ≡ Available individually or for attachment to a cleaning basin.

ITEC GmbH

Auf dem Tigge 60 b + c
D-59269 Beckum/Westfalen
Germany

Phone +49 25 21 / 85 07 0

Fax +49 25 21 / 85 07 90

www.klin-itec.de · info@klin-itec.de



Stainless steel folded paper towel dispenser

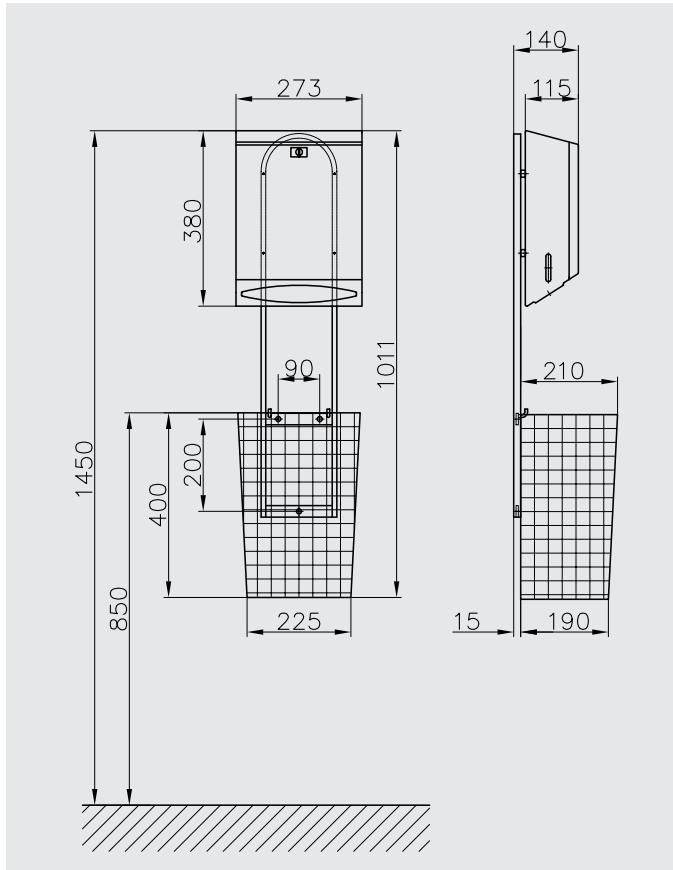

Technical data: Stainless steel folded paper towel dispenser Typ E

Dimensions (W x H x D): 273 x 380 x 115 mm

Dispenser capacity: 480 towels

Waste paper basket capacity: 18 litres

Weight: 3 kg

Technical data subject to change.

ITEC GmbH

Auf dem Tigge 60 b + c

D-59269 Beckum/Westfalen

Germany

Phone +49 25 21/85 07 0

Fax +49 25 21/85 07 90

www.klin-itec.de · info@klin-itec.de

